

clean and safe insulating:

EasyClean-Pan[®]



If hygiene is important for you.

The clean solution for you:

EasyClean-Pan[®]

A special joint KL 25

B high durability surface

C round corners

■ PS 20 SE insulating material core

slot and feather connection **■**

roomsized elements **D**

E stain resistant, visible fixing

Some mounting elements (Cross-sectional drawing)

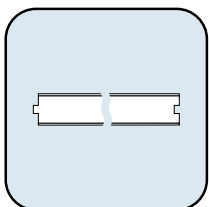

wall- or ceiling-
element

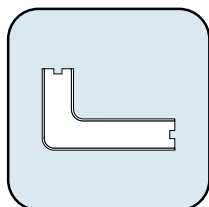

corner- modul
round corners
at the inside an
at the outside

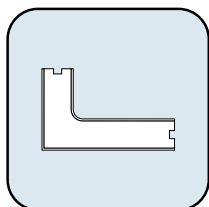

corner- module
round corners
at the inside

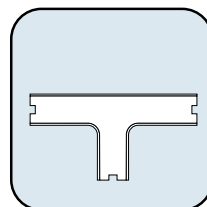

T- module

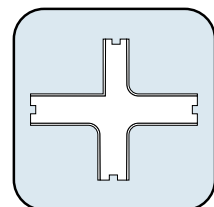

X- module

Brief information concerning EasyClean-Pan productline by ECP

EasyClean-Pan® was developed for extremely stressed rooms in the food processing industry and has already been mounted several times, leaving the builder owners highly satisfied.

In these rooms the ceilings and walls have to cope with extreme stress like variations of temperature, high humidity, mold, lactic acid, salt, fats, aggressive detergents and disinfectants for a long time.

EasyClean-Pan® has proved to be excellent in rooms where cheese is kept for ripening, this is where all conditions noted occur.

Description of the productline

- Surface:** GRP 2,0 mm with Gelcoat surface preparation, highly shock resistant, mechanically as well as chemically highly resistant, low abrasiveness, physiologically
- Joints:** safe joint compound KL 25 with solid surface
- Round corners:** vertical corners in the room are mounted with rounded corner moduls without profiles
- Insulating material core:** Polystrol hard foam PS 20 SE, WLG 040 or WLG 035 according to DIN 4108, refractory materials class B1 according to DIN 4102 (as compound element B2)
- Element connection:** slot and feather connection without transmission of cold
- Element size:** standard type 1.200 mm
Lenght according to location up to about 6 m
strenght from 120 mm on
prefabrication of all panels and corner moduls in the factory
according to mounting instructions
- Mounting conditions:** Range of temperatures 0 degrees centigrade to 25 degrees centigrade or according to demand

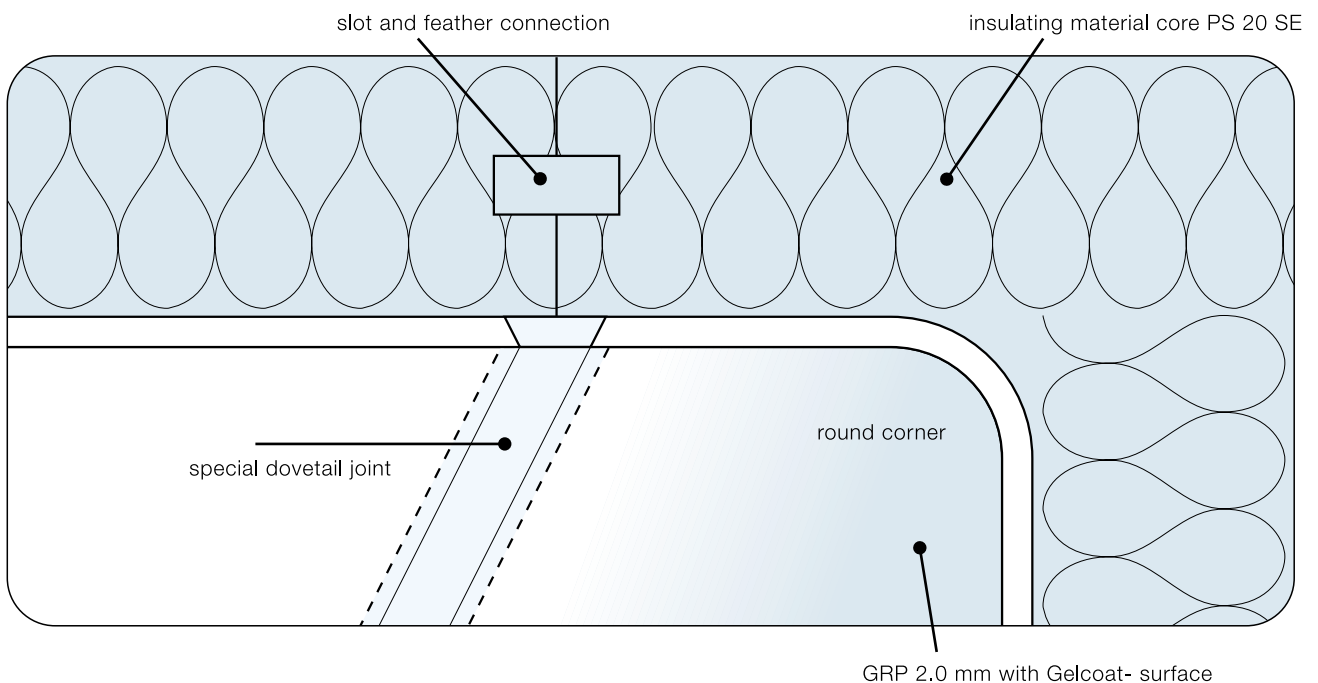

EasyClean-Pan® is robust!

No sun without shadows – if you work, damages on the walls may occur. So it is important that light blows leave no damages on the surface and that damages caused by heavy blows, should be easy to repair.

The "dropping a weight" experiment

An iron weight (5kg) is dropped on a panel surface made out of GRP and on a sheet metal surface from a height of 0,6m and 1,8m. Tiled surfaces were not included in the experiment, as they will be destroyed if the weight falls from a height of only 10cm.

www.ecp-gfk.de/dropping/



GRP after a drop from 0,6m



GRP after a drop from 1,8m

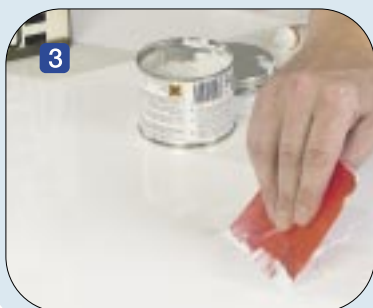

GRP – 0,6m (picture 1)

The weight bounces on the surface, it leaves a slight dent of about 1mm, hardly to be seen.

Sheet-metal – 0,6m

The weight causes a dent of about 5mm, which is clearly to be seen, an optical default.

GRP – 1,8m (picture 2)

The weight knocks a hole into the surface, the energy is swallowed by the insulating core. The damage is a 5mm deep hole with a diameter of about 10cm.

Sheet-metal – 1,8m

The weight causes a deep dent and a number of creases in the sheet metal. The damage is an 8mm deep hole with a diameter of about 30cm. In the case of damage of the varnish rust can be expected.

Simple repair of GRP-surfaces (picture 3)

Even bigger damages can be repaired easily.

Your advantage:

Quick repairs at little expense



Detailed information

Advantages of EasyClean-Pan®

A The Joint KL 25

In general joints are not welcome, but they cannot be totally avoided, as panels can only be manufactured and transported in limited size. Joints have to balance the changes in temperature in the surfaces and have therefore to be flexible. The familiar products made out of silicone or similar materials are flexible, but they withstand mechanical, biological and chemical stress only for short time, so they have to be renewed periodically. Stiff linkings of joints with polyester resin or similar materials can withstand biological and chemical stress, but they cannot balance the stretching of the surface, they tear up. The joint compound KL 25 combines all necessary features and balances the tensions in the surface of the GRP panels – it is rigid as far as the surface is concerned, so it cannot be attacked by fungus etc.. The joint compound KL 25 is physiologically safe and releases no fungicides. The application of the joint compound will be handled by specially trained staff only.

**Only ECP offers
EasyClean-Pan® with KL 25
Joint Compound**

B The surface of GRP 2,0mm panels with Gelcoat-reinforcement

GRP (glassfibre reinforced polyester) has proved successful for about 20 years, not only in shipbuilding but also in the foodprocessing industry. The material is stainless, smooth, bright and easy to be cleaned. The material has an extreme resistance to shocks with its thickness of 2,0mm. The surface is even smoother and easier to clean because of the Gelcoat-surface reinforcement which seals the glass fibre structure. If the surface happens to be damaged in the rough course of day to day work – the damage can be repaired without any problem by using some surfacer.

C Round Corners

Often the vertical roomcorners are difficult to clean. The usual covering squares leave cavities where dirt and leakwater accumulate. Fixing elements like screws and rivets are disadvantageous too as far as cleaning and room hygiene are concerned. Our round corners have no cavities, rivets, screws or angles. The round corners form a homogeneous surface with the wall panels next. This does not only look good, the food control authorities love it.

D Prefabricated Moduls

First we check the local dimensions, than we set up a mounting schedule with specifications according to the blueprint presented. This is basic for a true to size production of the elements and corner modules, which are left to be fitted together at the building site. Normally cut to size at the building site is only necessary as far as doors and windows are concerned. This procedure reduces the costs for mounting at the building site to a minimum, furthermore the quality of the product is increased by the cut to size in the factory. The mutual control between the blueprint presented and the mounting schedule is an advantage for the architect and the builder owner, as it enables them to foresee possible problems which could turn up in the course of the building process. By having such a detailed parameter faults occurring when the mounting takes place can be excluded to a high degree. The builder-owner can trust to get high quality for his money.

E Fixing Elements

No visible fixing elements like squares, screws, rivets etc. are necessary with **EasyClean-Pan®**. If mechanical fixing elements are necessary the application will be concealed. Even ceilings can be lowered without visible girder profiles.



EasyClean-Pan® was the right alternative for us!

In the course of three generations we enlarged and renovated our enterprise several times. So we tried out many things, constructional defects like molded joints, dirt-corners and stained profiles as well as loosening paint coatings on sheet metal turned up continuously. The existing systems were Just not elaborated enough.

Having **EasyClean-Pan®**, constructional defects are no longer causing trouble, so we can concentrate on what we know best to do: Our job!